

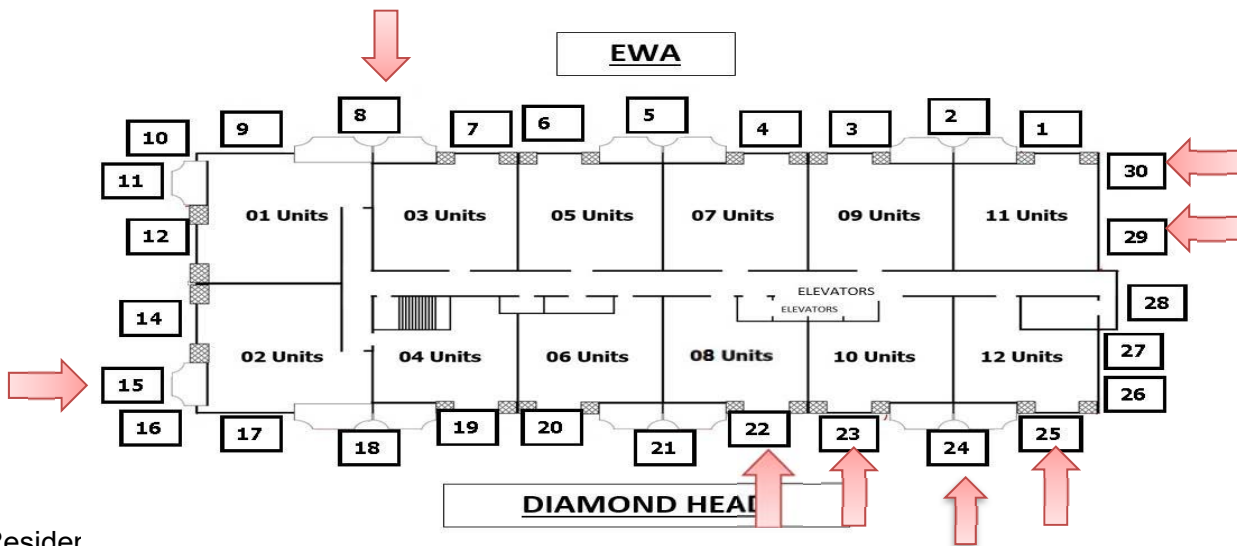

1350 ALA MOANA

# Building Exterior Repair Schedule

<u>Dates</u>	<u>Location</u>	<u>Activities</u>
August 6 – 10, 2018	L7 & PH7 Mauka Side	Paint
August 6 – 14, 2018	Drop 25	Paint and bird nets
August 6 – September 7, 2018	Drop 29 & 30	Caulk and paint
Scaffolding equipment will remain on the Mauka side of L7 through September 7.		
August 6 – 17, 2018	Drop 15	Paint
August 6 – September 14, 2018	Drop 8	Spall repair, caulk and paint
August 6 – October 31, 2018	Garage	Mobilize, prep, spall repair, caulk and paint
August 6 – September 14, 2018	Drop 23	Mobilize, prep, spall repair, caulk, paint and bird nets
August 20 – September 28, 2018	Drop 22	Mobilize, prep, spall repair, caulk, paint and bird nets
August 21 – November 30, 2018	Drop 24	Mobilize, prep, spall repair, caulk and paint



Dear Resider...

Work hours are from 8:00am to 4:30pm, Monday through Friday. There will be loud jackhammering and grinding noises throughout the day. Please keep the windows closed on the stacks where the swing stage is located to prevent dust from entering the units and keep your curtains drawn for privacy as workmen and consultants will be passing by each unit daily. Please observe all cordoned off areas and abide by all warning signage.

If you have any concerns with the work that has been performed on your lanai, please contact Meti Rama at 841-7602 or [meti@sealmastershawaii.com](mailto:meti@sealmastershawaii.com).